

**Alternative AL40 Edge Retention / Drainage Trim Detail Available**  
See Alternative Detail Shown  
**(For Slopes Over 10° AL40 MUST BE USED)**

**Upstand**  
(Drg.No: D0901-00W\_3Deg+\_201-Ext-XF301\_001)

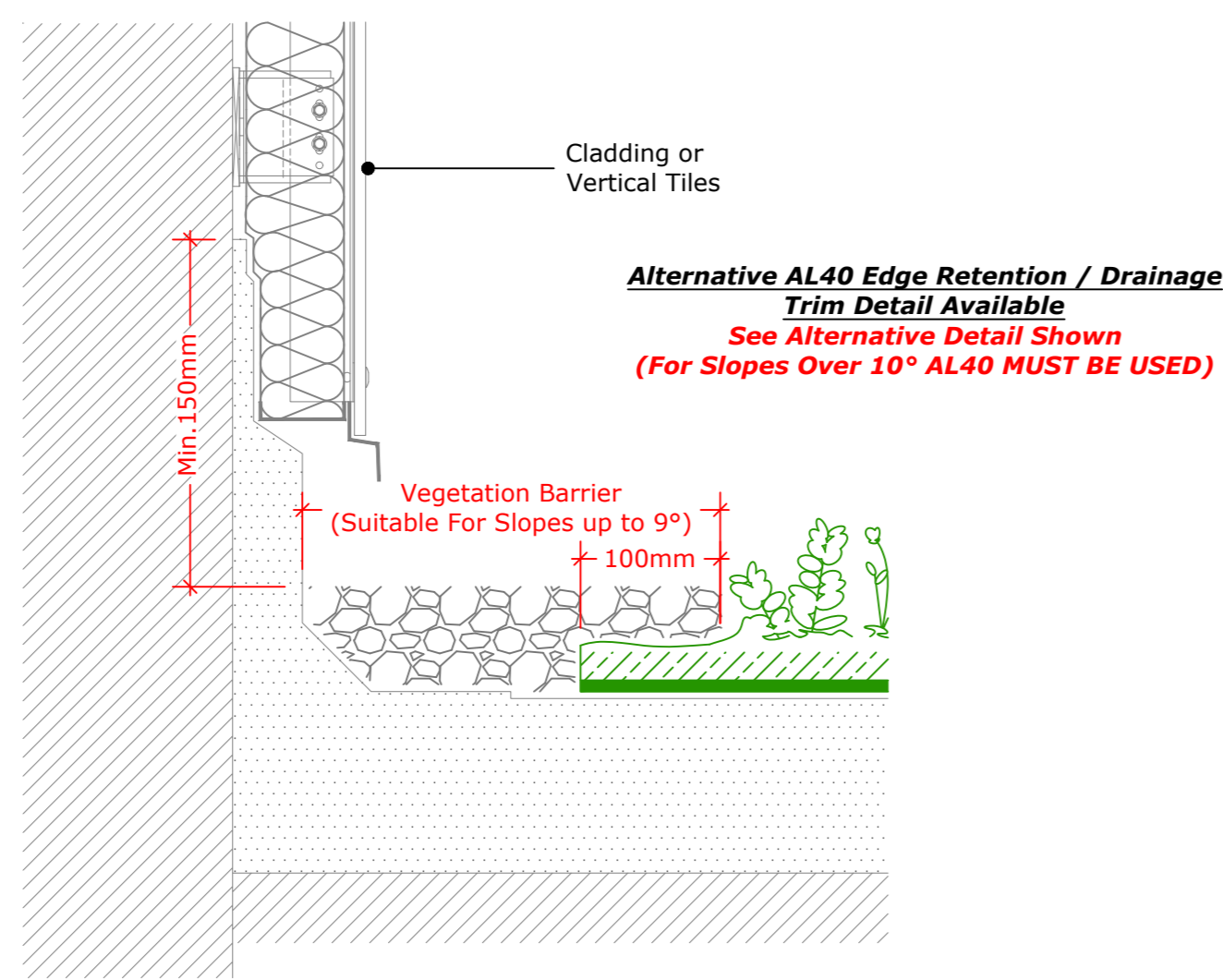

**Alternative AL40 Edge Retention / Drainage Trim Detail Available**  
See Alternative Detail Shown  
**(For Slopes Over 10° AL40 MUST BE USED)**

**Upstand to Vertical Cladding or Slates/Tiles**  
(Drg.No: D0901-00W\_3Deg+\_201-Ext-XF301\_002)

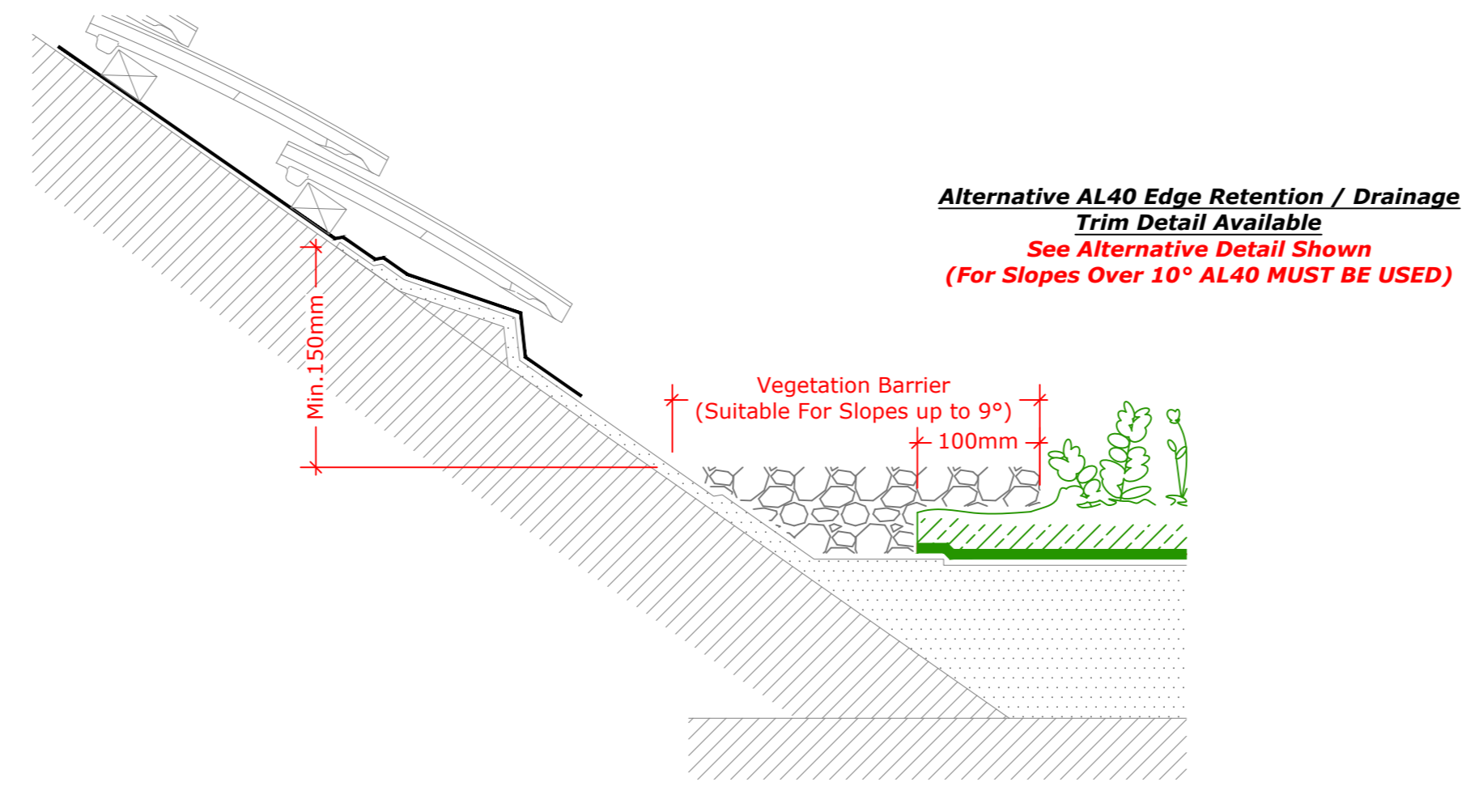

**Alternative AL40 Edge Retention / Drainage Trim Detail Available**  
See Alternative Detail Shown  
**(For Slopes Over 10° AL40 MUST BE USED)**

**Upstand to Pitched Roof**  
(Drg.No: D0901-00W\_3Deg+\_001-Ext-XF301\_004)

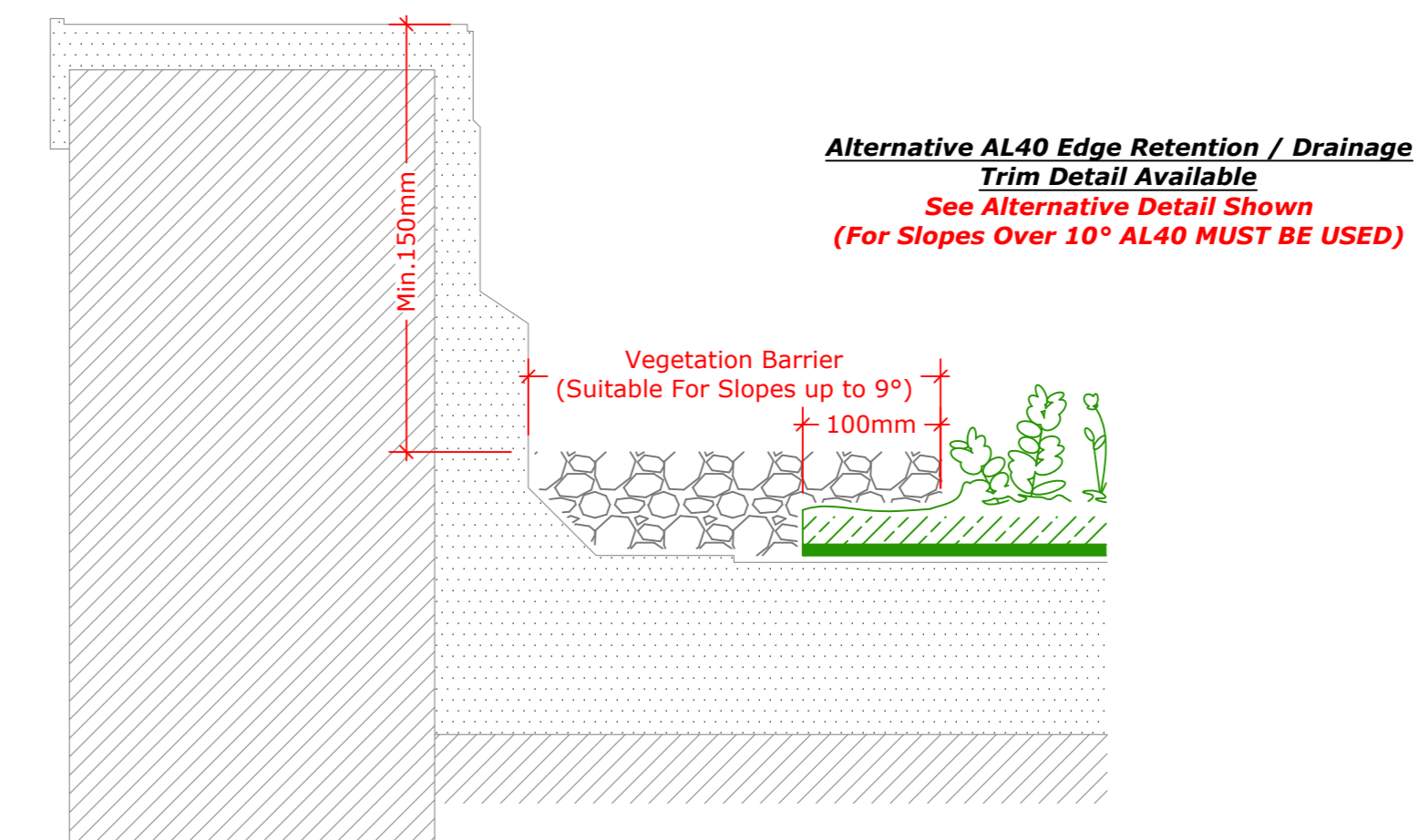

**Alternative AL40 Edge Retention / Drainage Trim Detail Available**  
See Alternative Detail Shown  
**(For Slopes Over 10° AL40 MUST BE USED)**

**Upstand to Parapet**  
(Drg.No: D0901-00W\_3Deg+\_203-Ext-XF301\_001)

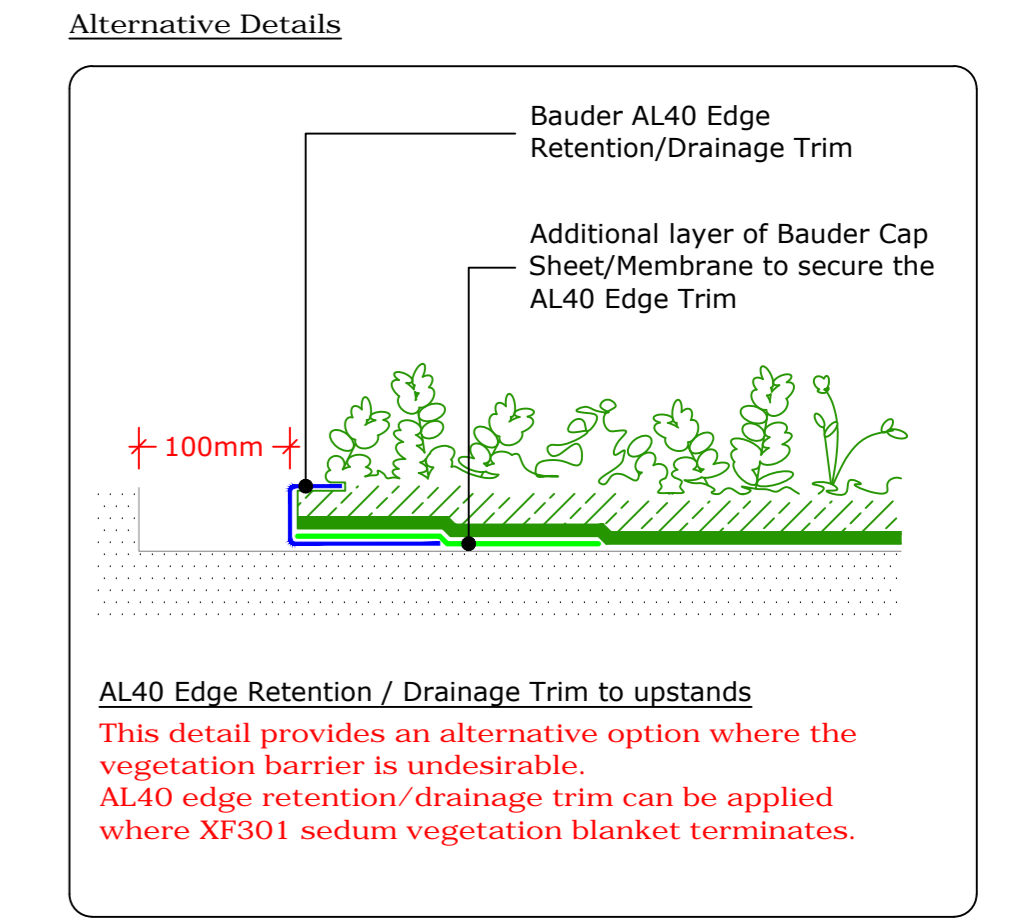

**AL40 Edge Retention / Drainage Trim to upstands**  
This detail provides an alternative option where the vegetation barrier is undesirable. AL40 edge retention/drainage trim can be applied where XF301 sedum vegetation blanket terminates.

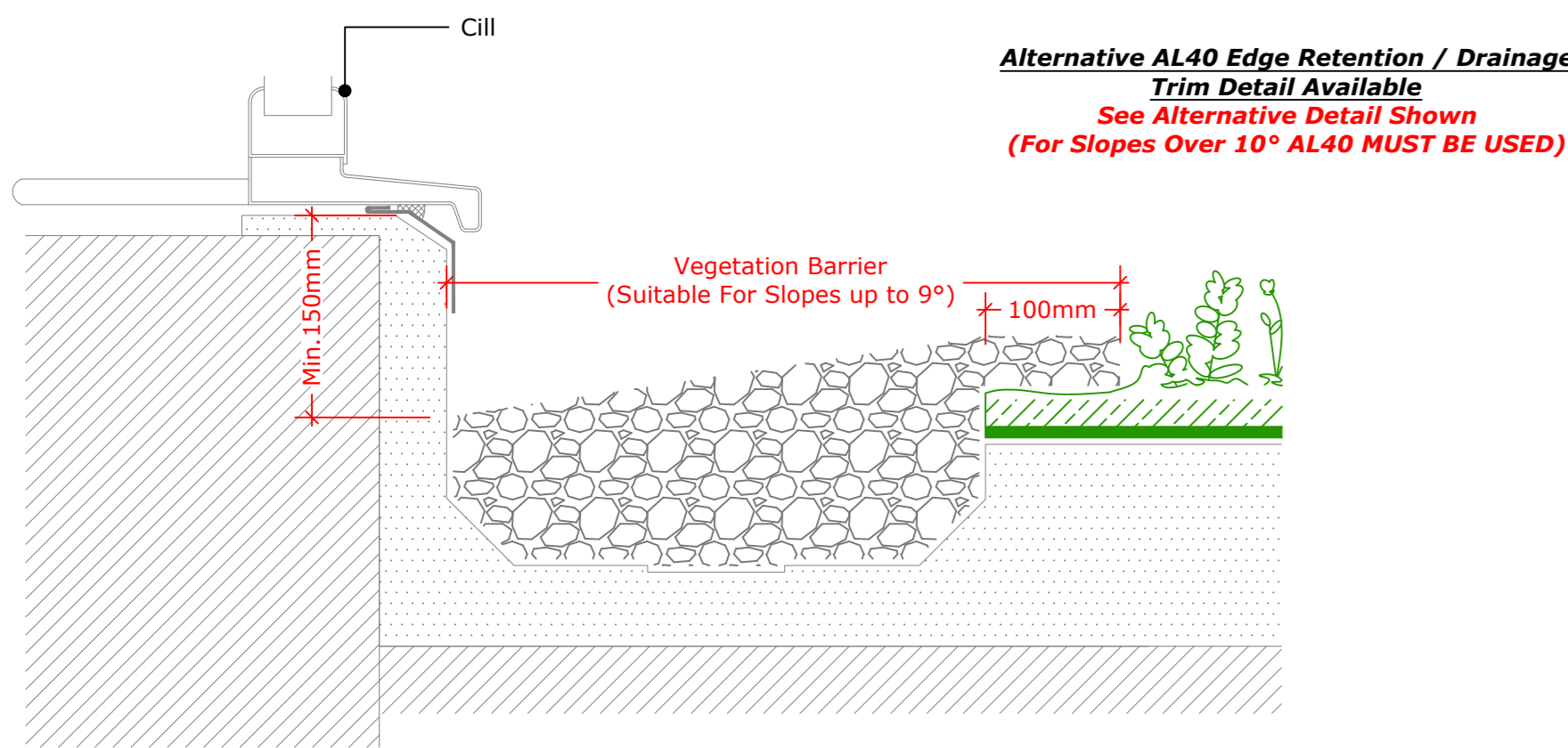

**Alternative AL40 Edge Retention / Drainage Trim Detail Available**  
See Alternative Detail Shown  
**(For Slopes Over 10° AL40 MUST BE USED)**

**Internal Gutter to Clerestory Window**  
(Drg.No: D0901-00W\_3Deg+\_206-Ext-XF301\_003)

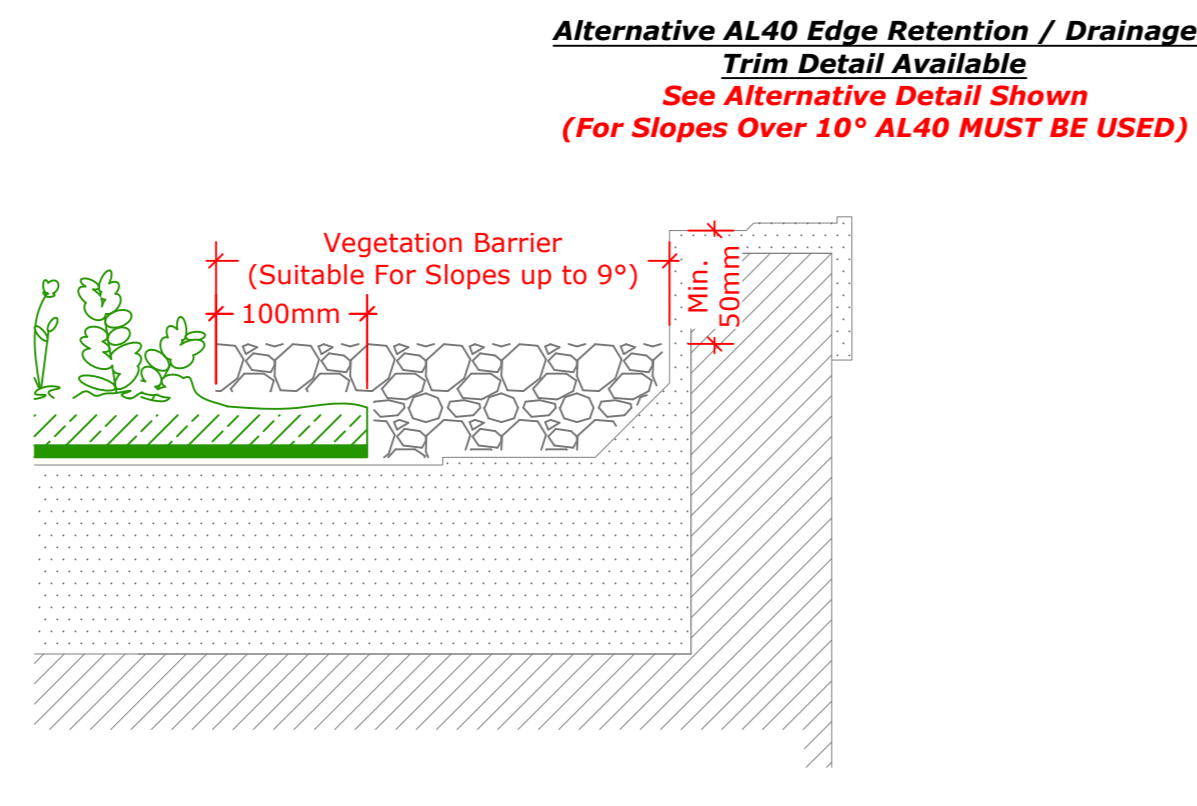

**Alternative AL40 Edge Retention / Drainage Trim Detail Available**  
See Alternative Detail Shown  
**(For Slopes Over 10° AL40 MUST BE USED)**

**Perimeter Kerb**  
(Drg.No: D0901-00W\_3Deg+\_002-Ext-XF301\_001)

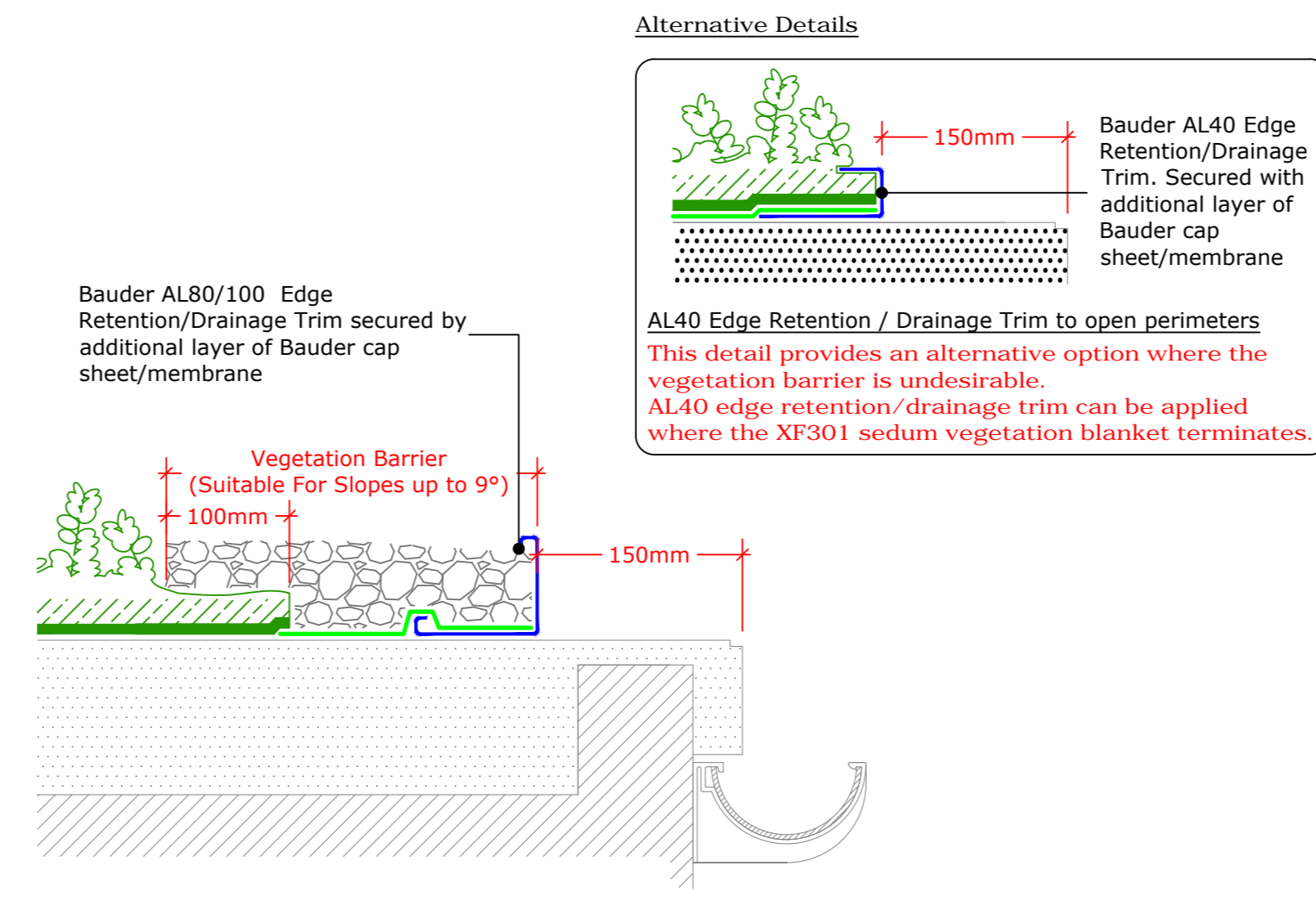

**Alternative Details**  
Bauder AL40 Edge Retention/Drainage Trim. Secured with additional layer of Bauder cap sheet/membrane.  
**AL40 Edge Retention / Drainage Trim to open perimeters**  
This detail provides an alternative option where the vegetation barrier is undesirable. AL40 edge retention/drainage trim can be applied where the XF301 sedum vegetation blanket terminates.

**External Gutter**  
(Drg.No: D0901-00W\_3Deg+\_006-Ext-XF301\_005)

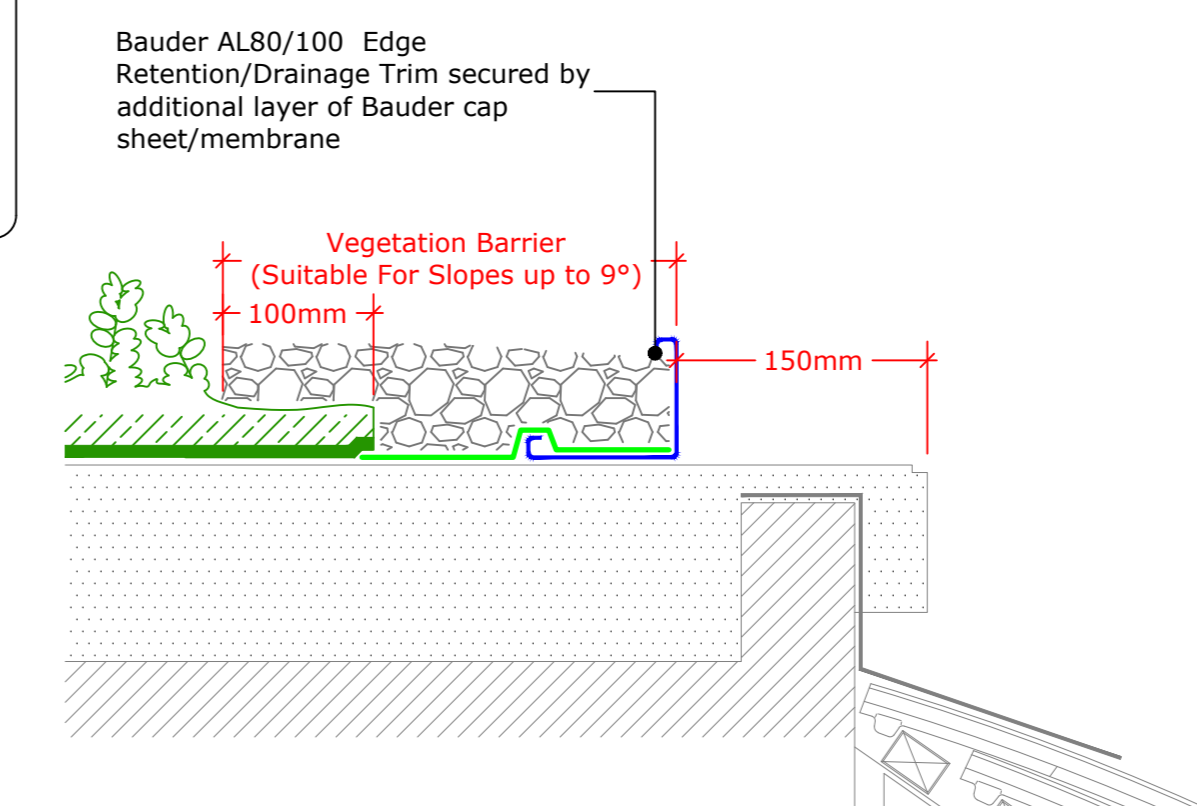

**Detail to Mansard Roof**  
(Drg.No: D0901-00W\_3Deg+\_006-Ext-XF301\_006)

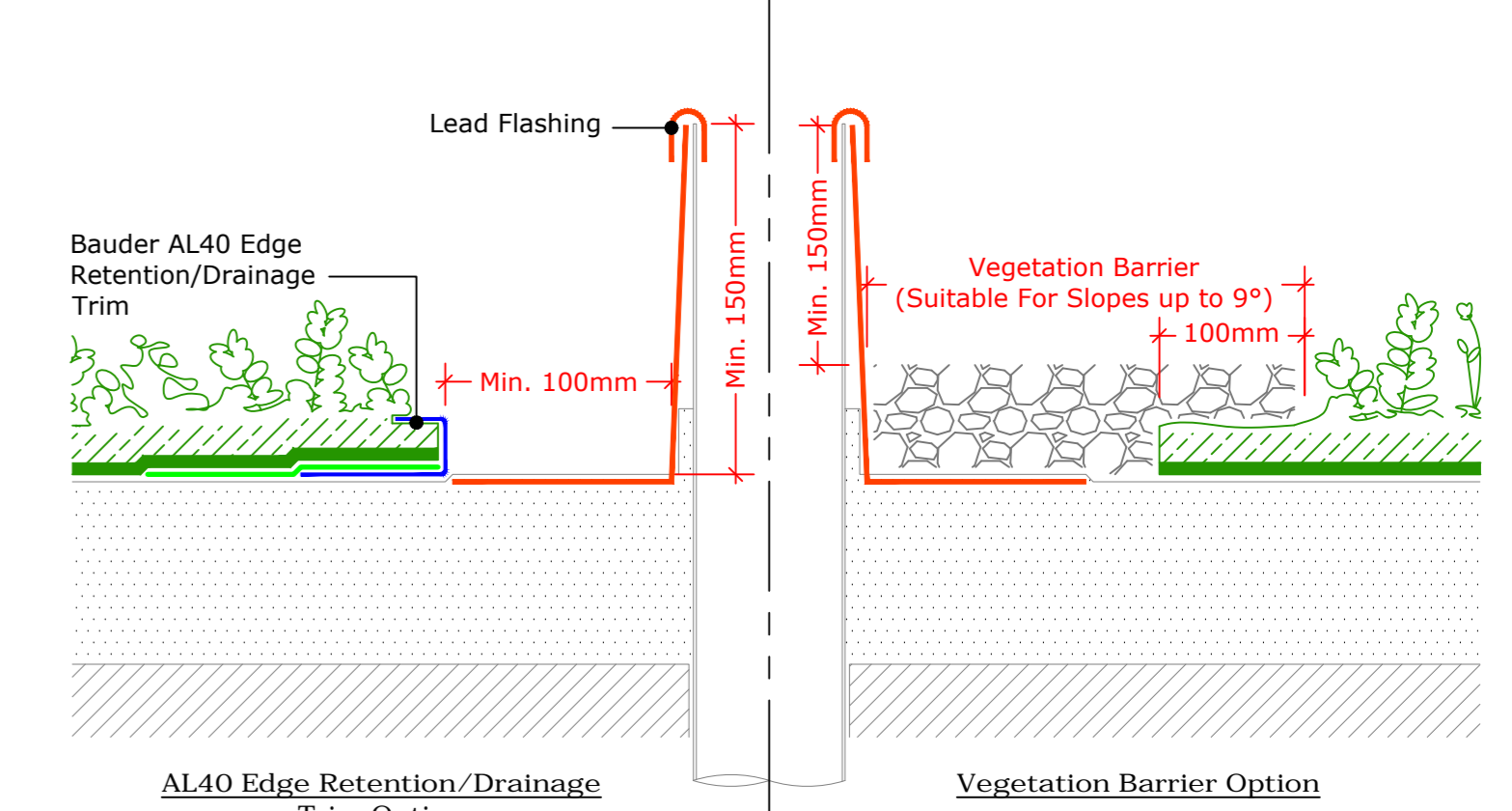

**Soil Vent Pipe**  
(Drg.No: D0901-00W\_3Deg+\_007-Ext-XF301\_001)

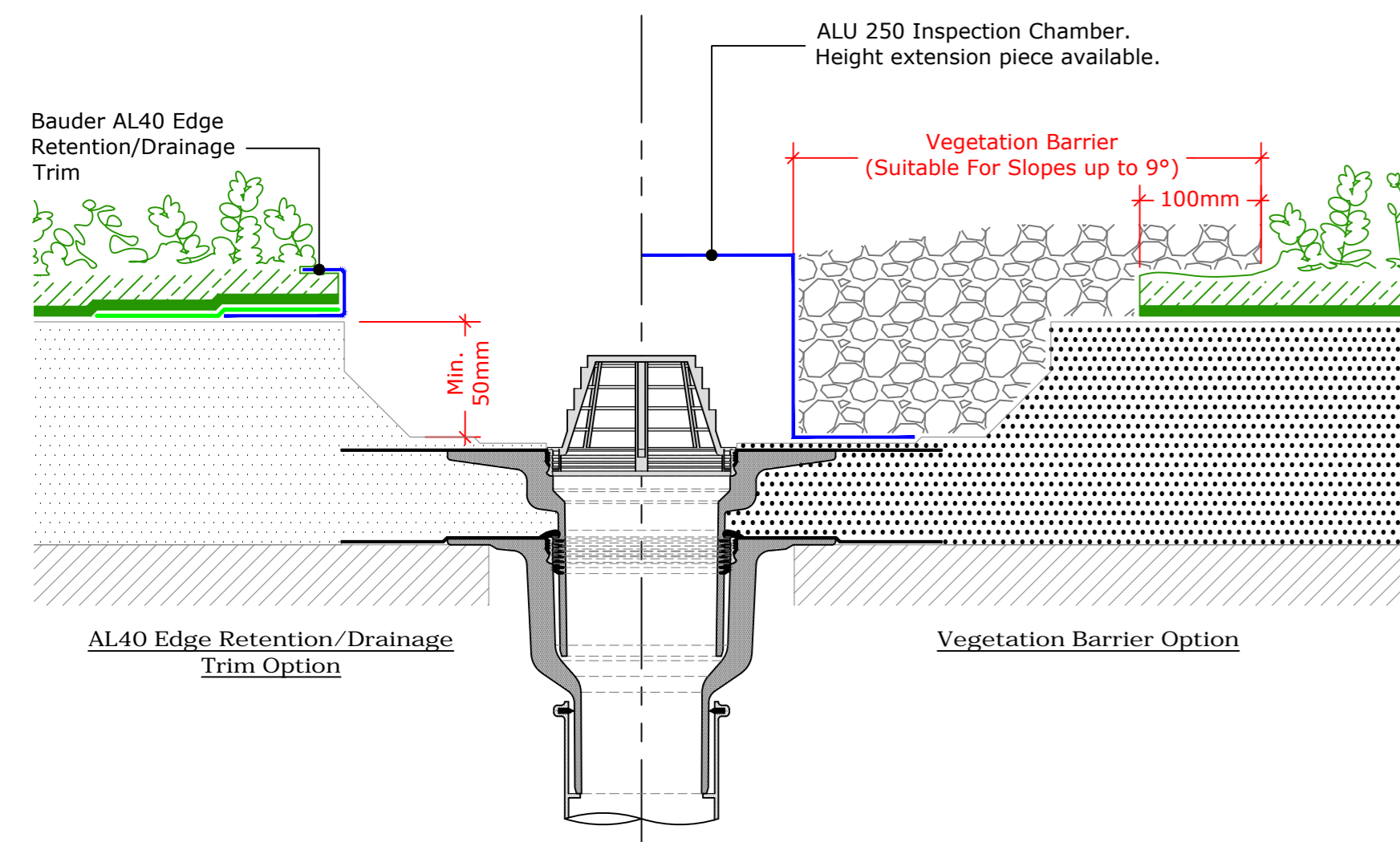

**Bauder Outlet - Compact**  
(Drg.No: D0901-00W\_3Deg+\_006-Ext-XF301\_001)

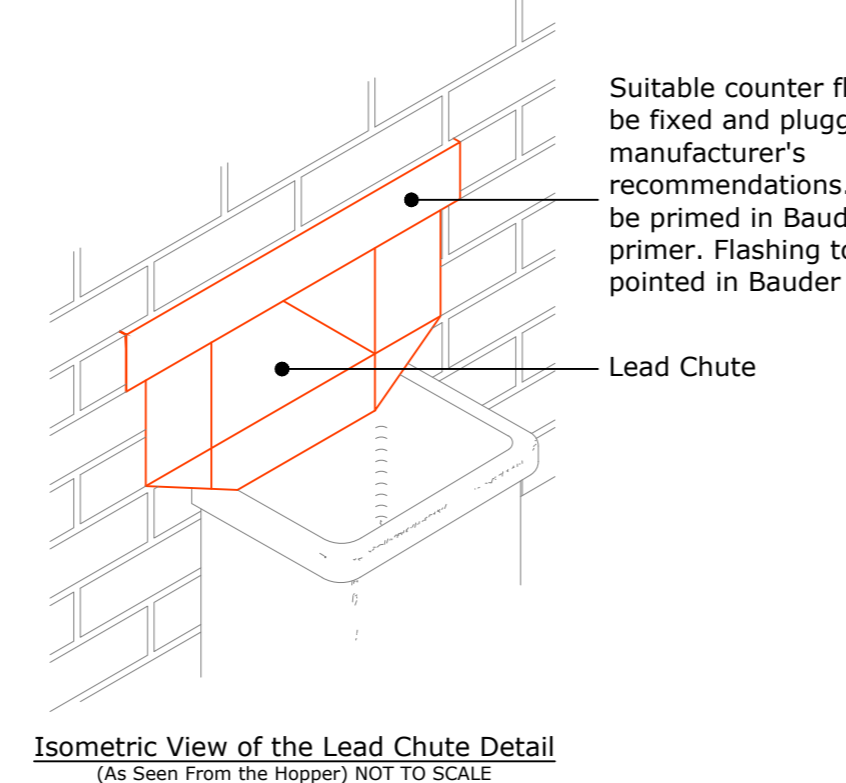

**Isometric View of the Lead Chute Detail**  
(As Seen from the Top) 10:1 Scale

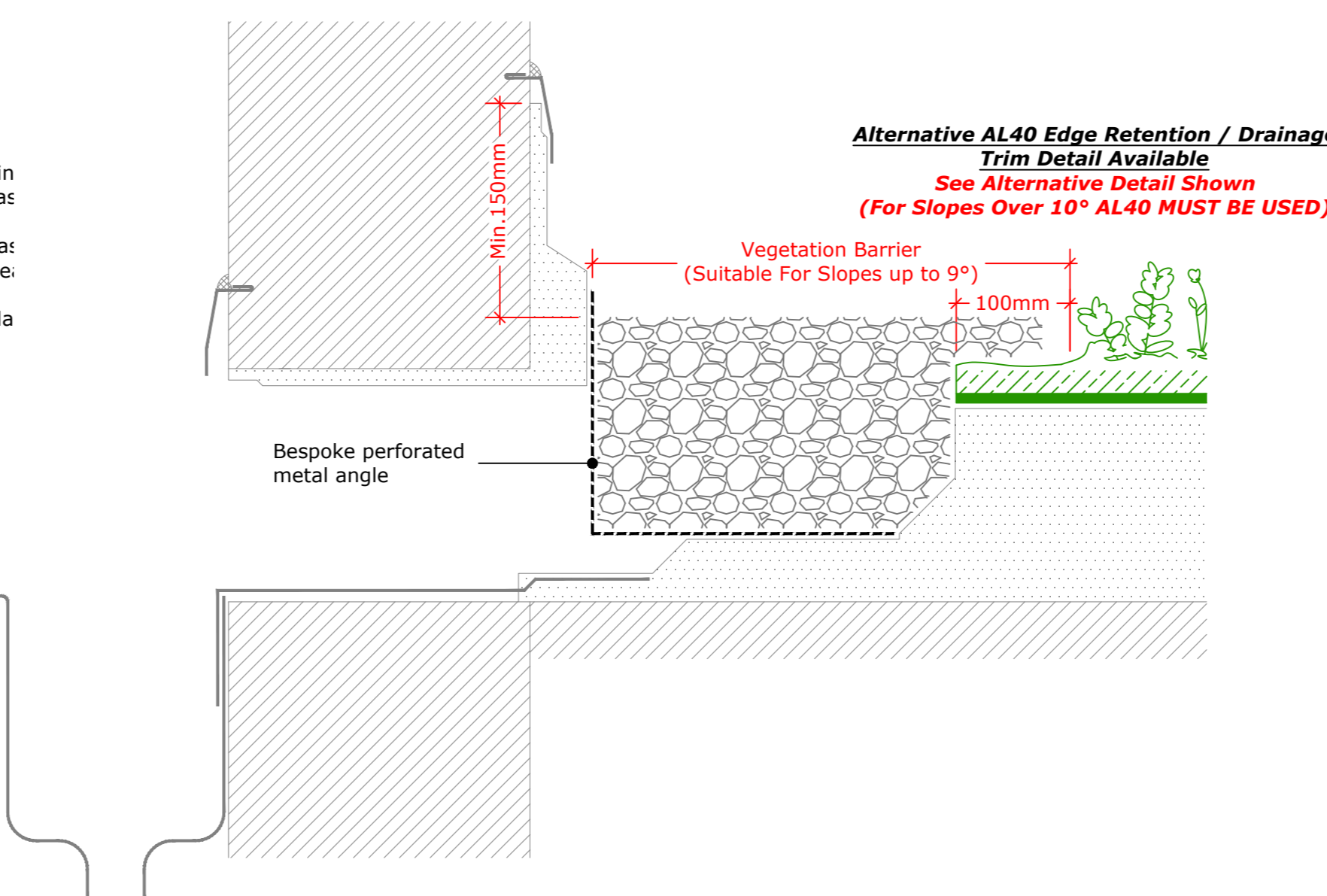

**Alternative AL40 Edge Retention / Drainage Trim Detail Available**  
See Alternative Detail Shown  
**(For Slopes Over 10° AL40 MUST BE USED)**

**Upstand - Lead Chute**  
(Drg.No: D0901-00W\_3Deg+\_206-Ext-XF301\_002)

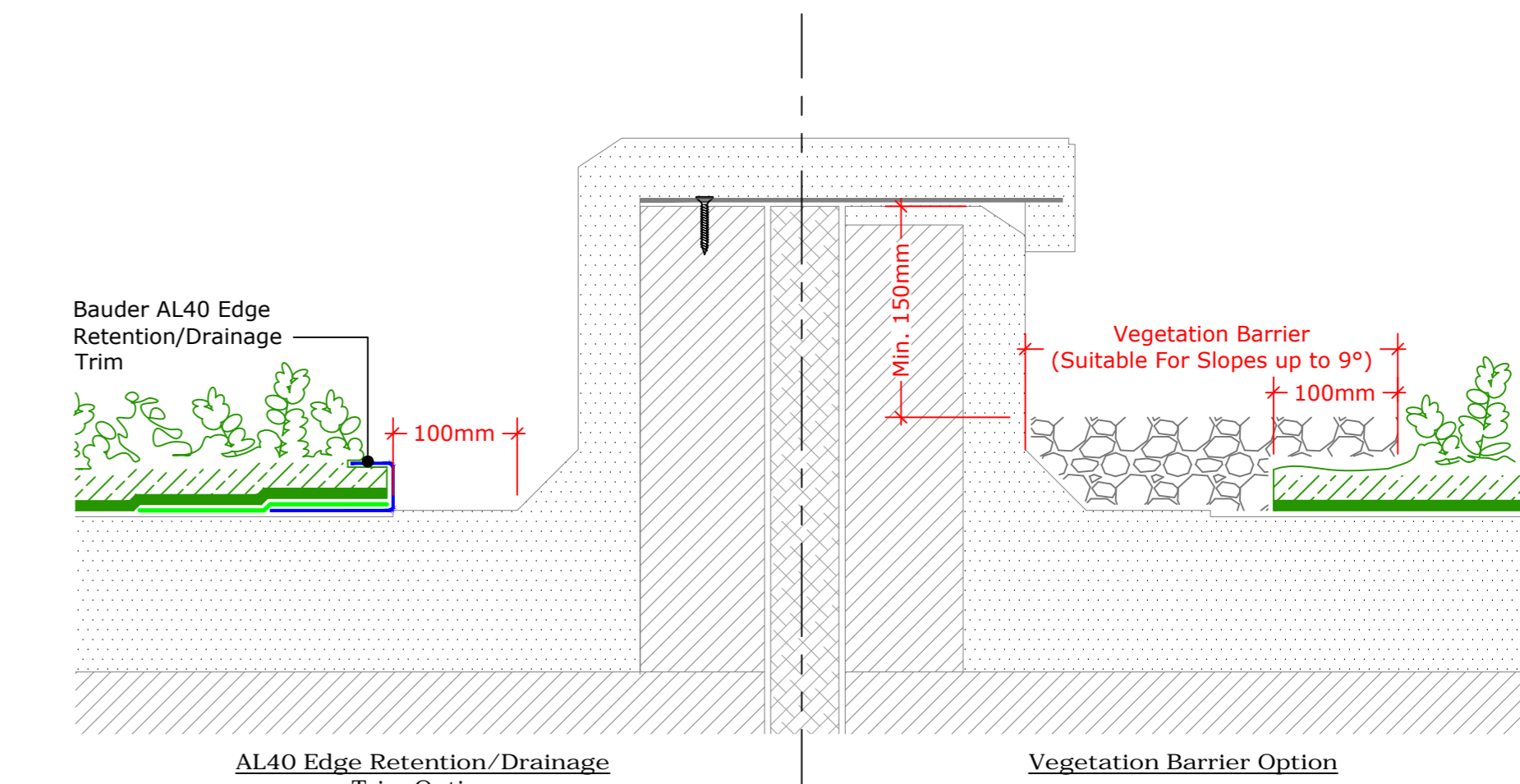

**Twin Kerb Expansion Joint**  
(Drg.No: D0901-00W\_3Deg+\_204-Ext-XF301\_001)

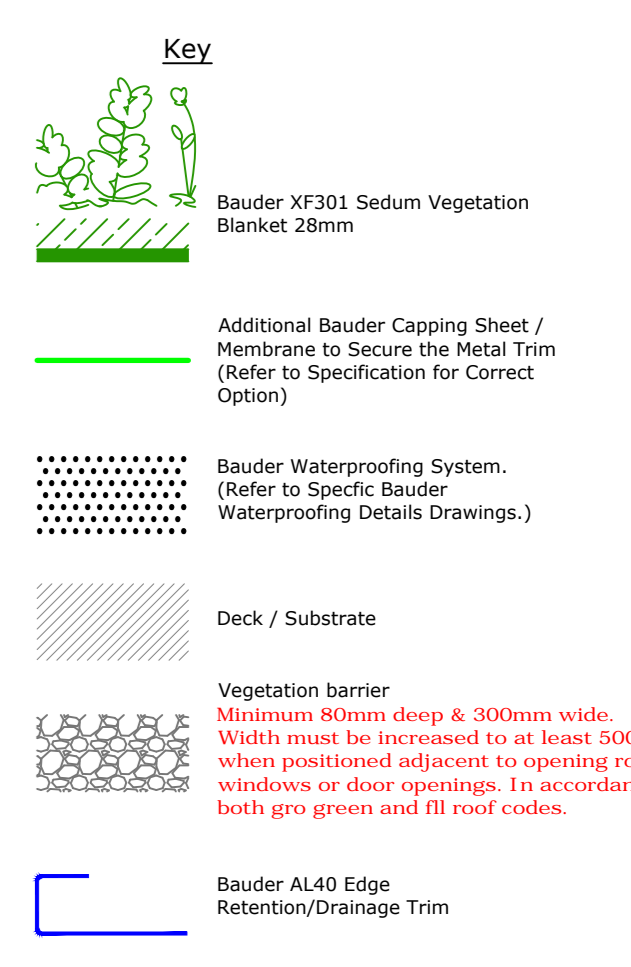

**Important note:**  
This drawing shows alternative details. For the correct solution to be used, refer to the project specific specifications.

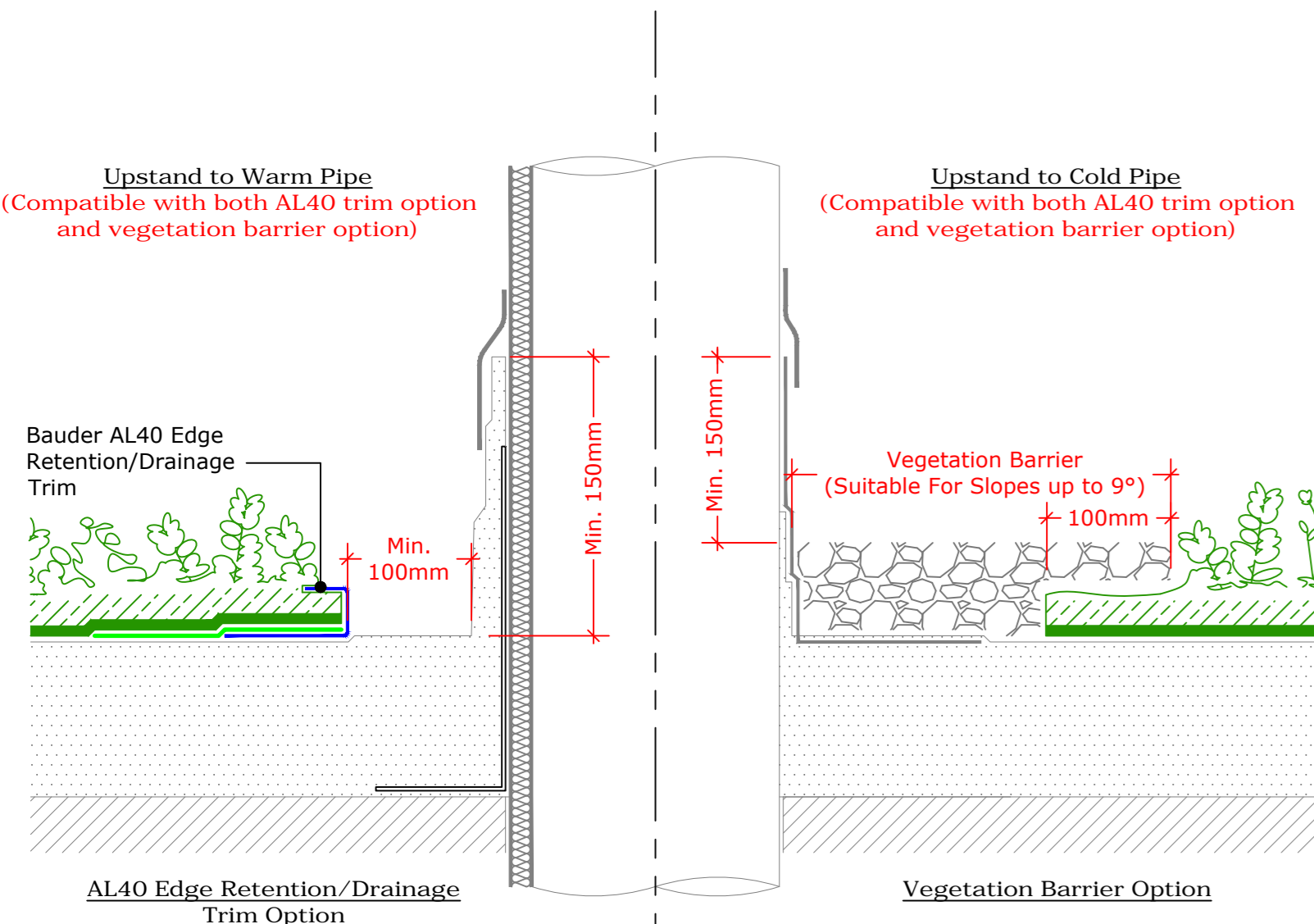

**Upstand to Hot Flue or Cold Pipe**  
(Drg.No: D0901-00W\_3Deg+\_007-Ext-XF301\_002)

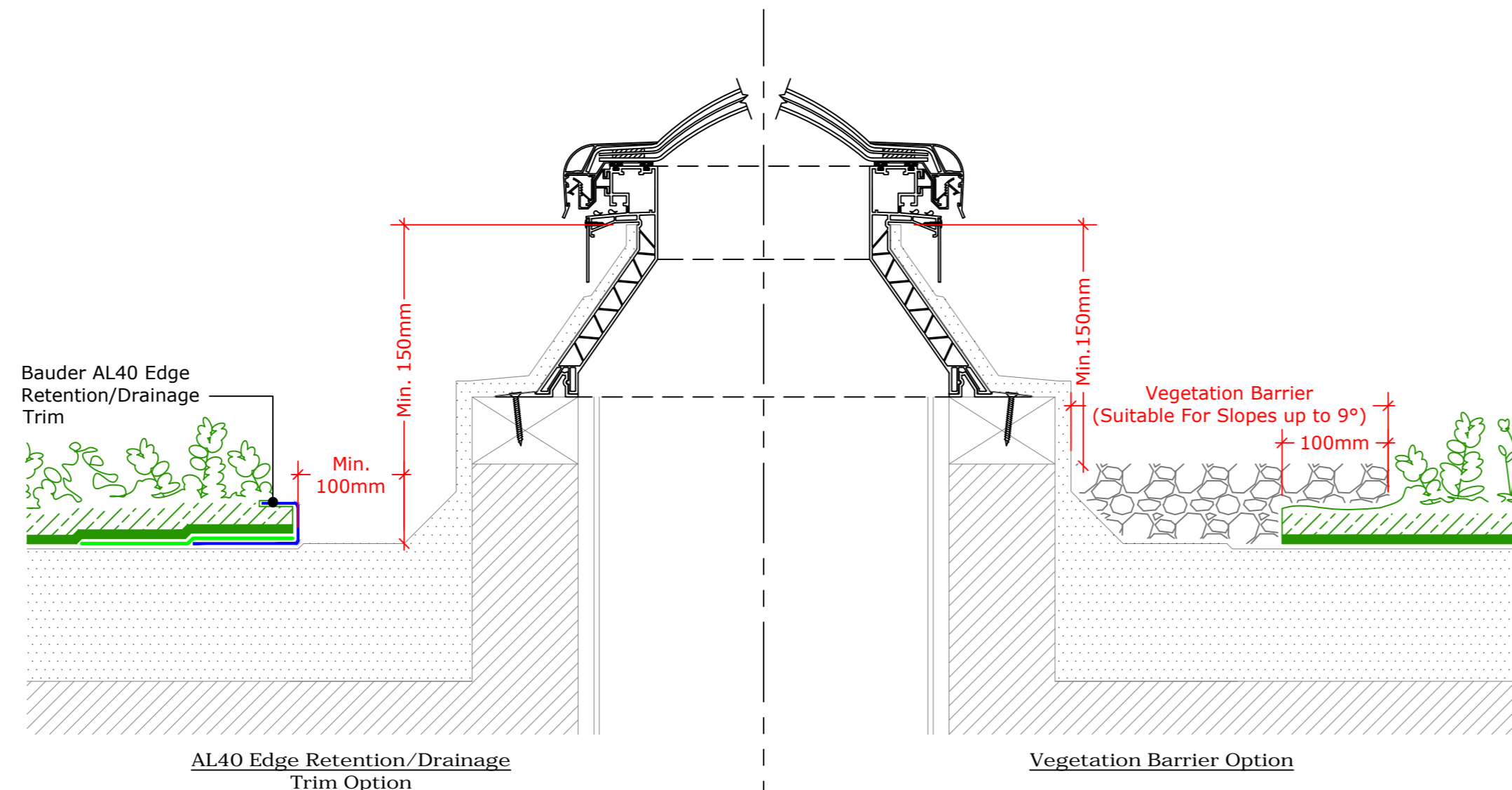

**Upstand to Bauder Rooflight - Euroglaze**  
(Drg.No: D0901-00W\_3Deg+\_008-Ext-XF301\_001)

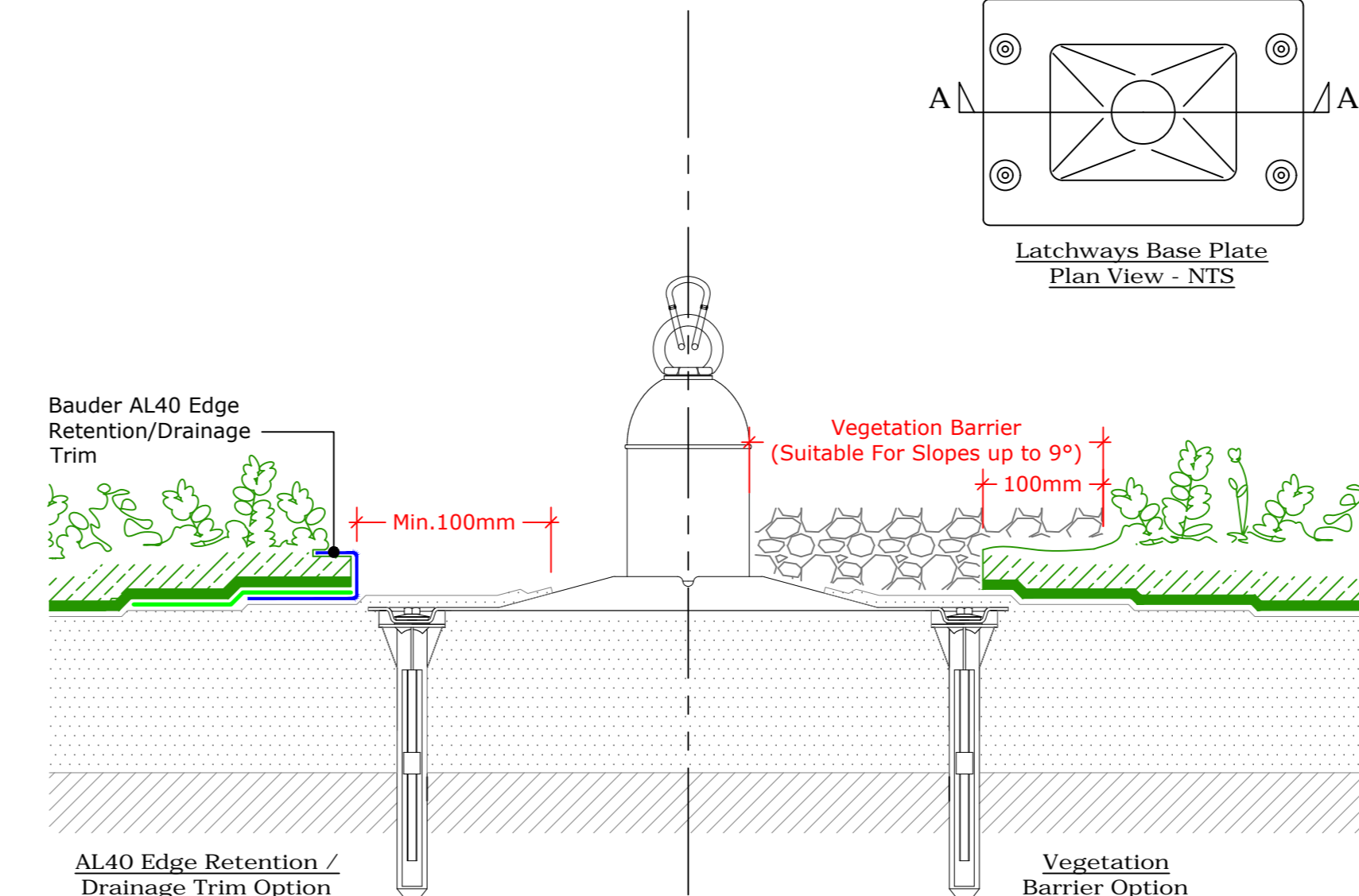

**Latchways Constant Force Post**  
(Drg.No: D0901-00W\_3Deg+\_009-Ext-XF301\_001)

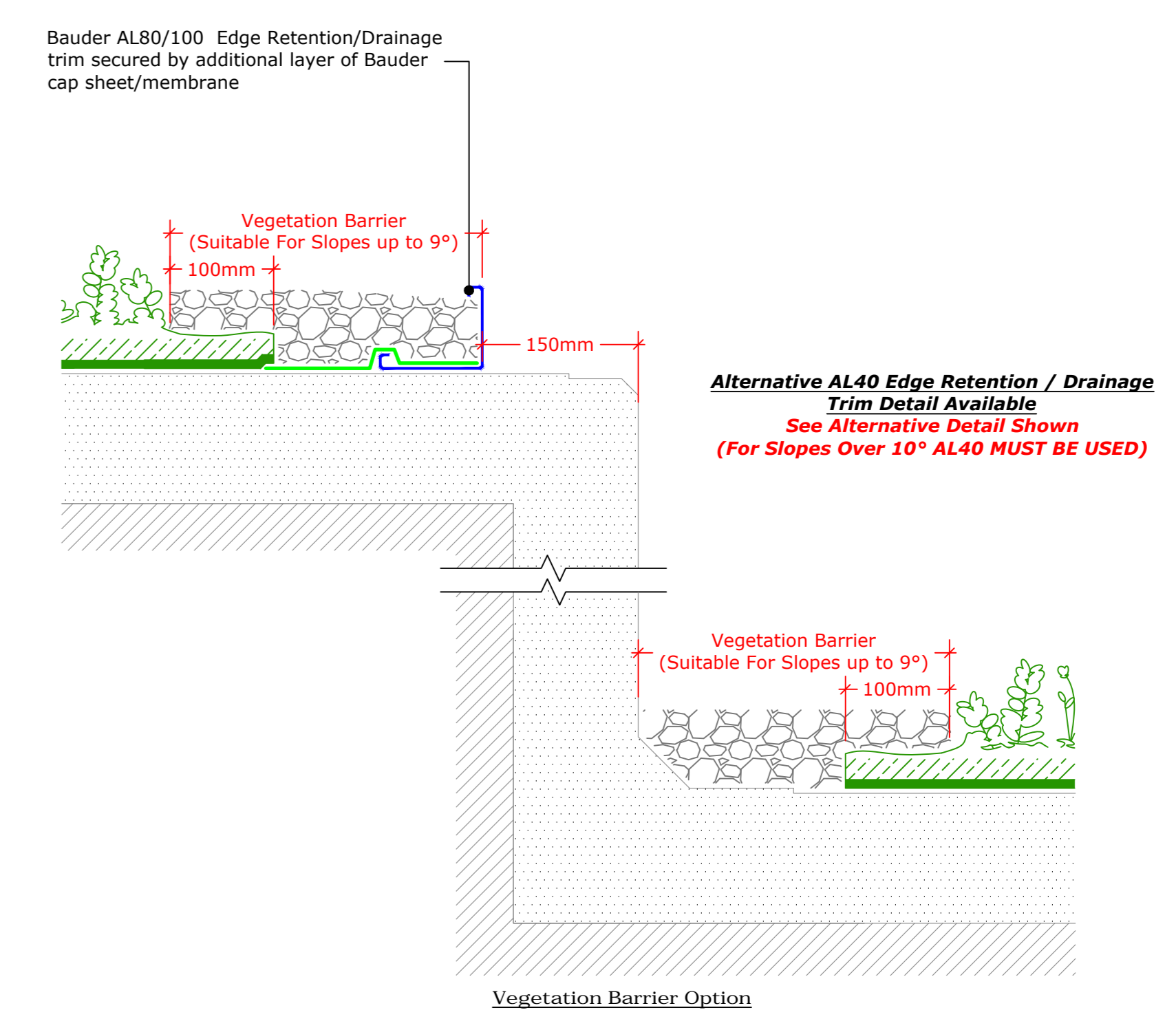

**Change In Level**  
(Drg.No: D0901-00W\_3Deg+\_210-Ext-XF301\_001)

- IMPORTANT NOTES:**
- This detail is suitable for the following Bauder Systems: Bauder Total Green Roof System BauderGreen.
  - This drawing shows Alternative Options. For the Correct Solution to be Used, Refer to the Project Specific Specifications.
  - Do not scale to ascertain dimensions.
  - All dimensions to be checked and verified on site prior to commencement of work.
  - This drawing is to be read in conjunction with the specification and associated drawings.
  - This detail is a guideline only, representing typical detailing conditions and illustrates the correct application of the above Bauder System. It may be necessary to modify this detail to suit specific project design constraints and conditions.
  - Refer to the Bauder Specification for the product description and method of application. For clarity the method of attachment has not been shown.
  - Provision should be made by the installer for maintaining the top leading edge of all upstand details in excess of 250mm in height using appropriate fasteners.

Rev	Date	Description	Drawn By

**BAUDER**

UK OFFICE  
Bauder Limited  
70 Lonslow Road, Ipswich,  
Suffolk IP1 0DN,  
England.  
Tel: +44 (0)1473 257671  
Fax: +44 (0)1473 230761  
Email: [info@bauder.co.uk](mailto:info@bauder.co.uk)  
[bauder.co.uk](http://bauder.co.uk)

IRELAND OFFICE  
Bauder Limited  
O'Duffy Centre, Cross Lane,  
Carrigrohane, Co. Wexford,  
Ireland.  
Tel: +353 (0)42 9692 333  
Fax: +353 (0)42 9692 879  
Email: [ireland@bauder.ie](mailto:ireland@bauder.ie)  
[bauder.ie](http://bauder.ie)